

CNW102 - Single Phase EMC Filter

Dimensional Information

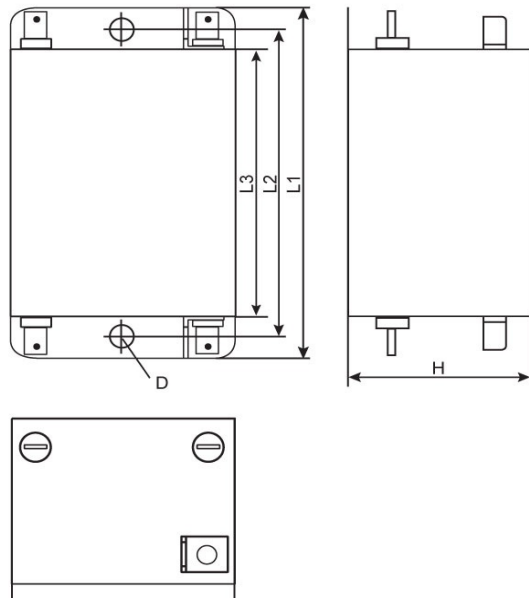

- compact construction
- easy installation
- touch-proof if used with insulated spade connectors
- very good damping performance at a low leakage current
- also as a medical version or with a lower leakage current available
- optional with overvoltage protection
- UL approval for the complete model range

Circuit Diagram

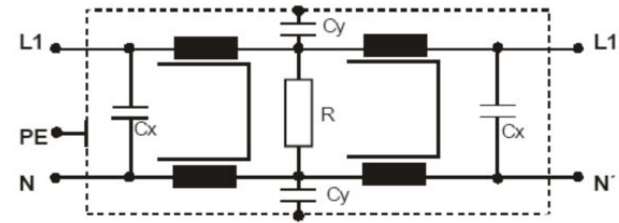

Typical Attenuation

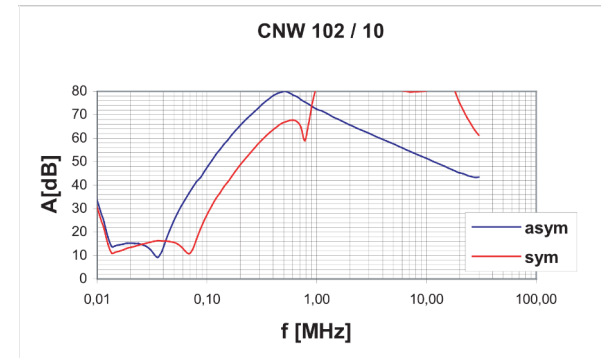

Type	Connection	PE-Connection	Dimensions					
			B mm	D mm	H mm	L 1 mm	L 2 mm	L 3 mm
CNW 102/3	6.3x0.8mm faston	6.3x0.8mm faston	50	5,3	40	87	75	65
CNW 102/6	6.3x0.8mm faston	6.3x0.8mm faston	50	5,3	40	87	75	65
CNW 102/10	6.3x0.8mm faston	6.3x0.8mm faston	50	5,3	40	87	75	65
CNW 102/16	6.3x0.8mm faston	6.3x0.8mm faston	53	5,3	40	110	100	90
CNW 102/20	6.3x0.8mm faston	6.3x0.8mm faston	53	5,3	40	110	100	90

Type	Rated voltage [V]	Rated current [A]	Leakage current [mA]	Cx [μF]	Cy [nF]	L [mH]	R [kOhm]
CNW 102/3	250	3	<3,5	0,94	20	13,6	560
CNW 102/6		6	<3,5	0,94	20	7,8	560
CNW 102/10		10	<3,5	0,94	20	3,6	560
CNW 102/16		16	<3,5	0,94	20	2,4	560
CNW 102/20		20	<3,5	0,94	20	2,0	560

Conforming to VDE 0565-3/IEC 950/UL 1283	Test voltage L-N 2100 V,DC 1s L/N-PE 2700 V,DC 1s
Overload 1,5 x I _{nom} 1 min / h	Climatic category DIN IEC 68-125/085/21

REO

Supplied by

**CONTROL
PANEL
PRODUCTS**